

- [Home](#)
- [About](#)
Abbatron
- [Products](#)
- [Locate](#)
Distributor
or
Representative
- [Contact Us](#)
- [Request](#)
Information
- [Site Map](#)

Plastic Cable Clamps

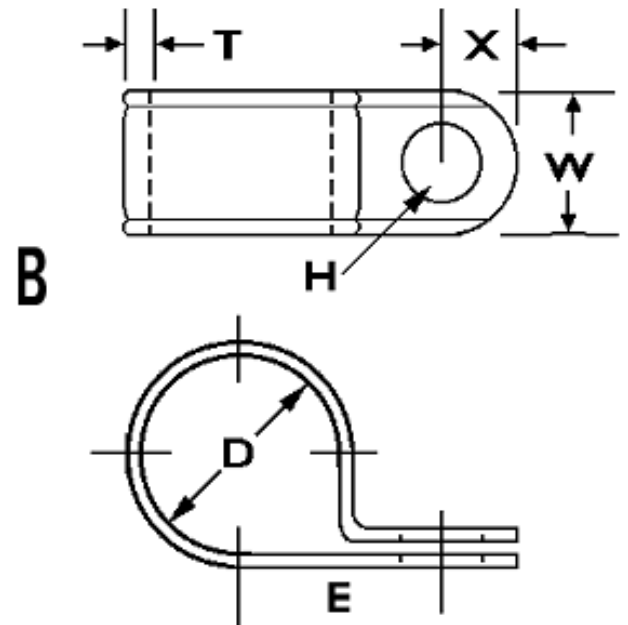
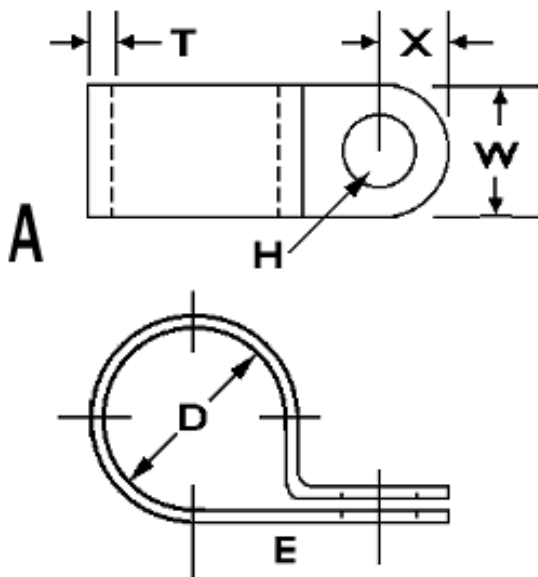

[Inventory Search](#)

[Cross Reference](#)

[UPS Tracking](#)

632 Arch Street, POB
726 Meadville, PA
16335 USA 814-724-
6440

[Contact Webmaster](#)

© June 6, 2005

PART #	ILLUS.	MATERIAL	COLOR	DIA.	E	T	W	X	H
8910	A	Polypropylene	Natural	1/8	.360	.060	1/2	7/32	13/64
8940	A	Nylon	Black	1/8	.360	.050	1/2	7/32	11/64
8955	A	Nylon	Black	1/8	.343	.050	3/8	7/32	11/64
8911	A	Polypropylene	Natural	3/16		.423	1/2	7/32	11/64
8941	A	Nylon	Black	3/16	.423	.050	1/2	7/32	11/64
8956	A	Nylon	Black	3/16	.378	.050	3/8	7/32	11/64
8912	A	Polypropylene	Natural	1/4	.457	.060	1/2	7/32	11/64
8942	A	Nylon	Black	1/4	.437	.060	1/2	7/32	11/64
8957	A	Nylon	Black	1/4	.409	.060	3/8	7/32	11/64
8913	A	Polypropylene	Natural	5/16	.498	.060	1/2	7/32	11/64
8943	A	Nylon	Black	5/16	.474	.060	1/2	7/32	11/64
8958	A	Nylon	Black	5/16	.441	.060	3/8	7/32	11/64
8914	A	Polypropylene	Natural	3/8	.529	.060	1/2	7/32	11/64
8944	A	Nylon	Black	3/8	.500	.060	1/2	7/32	11/64
8959	A	Nylon	Black	3/8	.471	.060	3/8	7/32	11/64
8915	A	Polypropylene	Natural	7/16	.560	.060	1/2	1/2	11/64
8945	A	Nylon	Black	7/16	.533	.060	1/2	1/2	11/64
8916	A	Polypropylene	Natural	1/2	.592	.060	1/2	7/32	13/94
8946	A	Nylon	Black	1/2	.553	.060	1/2	7/32	11/64
8961	A	Nylon	Black	1/2	.550	.060	3/8	7/32	11/64
8917	A	Polypropylene	Natural	9/16	.623	.060	1/2	7/32	13/64
8947	A	Nylon	Black	9/16	.603	.060	1/2	7/32	13/64
8918	A	Polypropylene	Natural	5/8	.654	.060	1/2	7/32	13/64
8948	A	Nylon	Black	5/8	.625	.060	1/2	7/32	13/64
8919	A	Polypropylene	Natural	11/16	.752	.060	1/2	7/32	13/64
8949	A	Nylon	Black	11/16	.665	.060	1/2	7/32	13/64
8920	A	Polypropylene	Natural	3/4	.783	.060	1/2	7/32	13/64
8921	A	Polypropylene	Natural	7/8	.845	.060	1/2	7/32	13/64
8951	A	Nylon	Black	7/8	.795	.060	1/2	7/32	13/64
8922	A	Polypropylene	Natural	1	.908	.060	1/2	7/32	13/64
8952	A	Nylon	Black	1	.825	.060	1/2	7/32	13/64
8925	B	Propionate	Amber	1/8	.328	.060	1/2	7/32	13/64
8926	B	Propionate	Amber	3/16	.390	.423	1/2	7/32	11/64
8927	B	Propionate	Amber	1/4	.421	.060	1/2	7/32	11/64
8928	B	Propionate	Amber	5/16	.453	.060	1/2	7/32	11/64
8929	B	Propionate	Amber	3/8	.483	.060	1/2	7/32	11/64
8931	B	Propionate	Amber	1/2	.562	.060	1/2	7/32	13/94
8932	B	Propionate	Amber	9/16	.625	.060	1/2	7/32	13/64
8933	B	Propionate	Amber	5/8	.610	.060	1/2	7/32	13/64
8934	B	Propionate	Amber	11/16	.666	.060	1/2	7/32	13/64
8936	B	Propionate	Amber	7/8	.812	.060	1/2	7/32	13/64